

# XANTÉ X-55™

- **BIGGER**
- **FASTER**
- **BUILT FOR PRODUCTION**



***Prints up to 55"x50"!***



***PRINT ON VIRTUALLY ANY MEDIA!***

***CMYK + WWW***

***UP TO 2880 DPI RESOLUTION***

***PRINT ON MEDIA UP TO 3 INCHES TALL***

***DUAL LED LAMPS***  
(Instant Ink Curing)



US: 251.473.6502  
EU: +31 (0) 26.319.3210

***xante.com***

# BEST. EVER.

The X-UV Printer cannot be beat.

*Large flatbed printers designed for signage and graphics print at high speeds, but are limited by substrate thickness.*

*Small format printers designed for specialty items print at slower speeds and are limited by substrate length and width.*

*The Xanté family of X-UV Printers do **BOTH**.  
It's the best of both worlds.*



***Signage • Manufacturing • Specialty Items • Industrial***

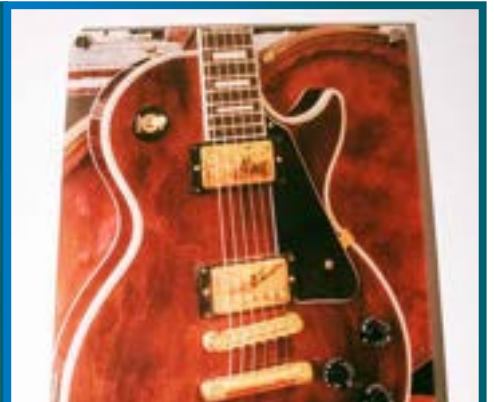

***CONTACT US TODAY FOR MORE INFORMATION.***

**251.473.6502**





*Simply Brilliant Color Workflow*

## Welcome to iQueue Prepress Software

Xante builds on its innovative workflow software with powerful team-based productivity in iQueue 14. True server-client operation enhances your workflow to optimize the talents and time of everyone involved in production. Take advantage of your entire team of IT

Create a new job or simply drag and drop your file into the queue.



### iQueue features include:

- Fully Independent CMYK Controls
- PANTONE® Color Library
- Right-ON® Spot Color Matching
- Full Imposition and Tiling
- QR Code Generator
- PDF-Out AND SO MUCH MORE!



specialists, designers, and printer operators to simplify prepress tasks such as job sharing and job cost estimating, file editing tools, patented Right-ON® Spot Color Matching and much more. Create attention-grabbing displays with VividHD-UV ink. And, with instant curing, your customers will appreciate the fast, durable results.

## White Options

Build depth with layers of white

Change spot colors to white

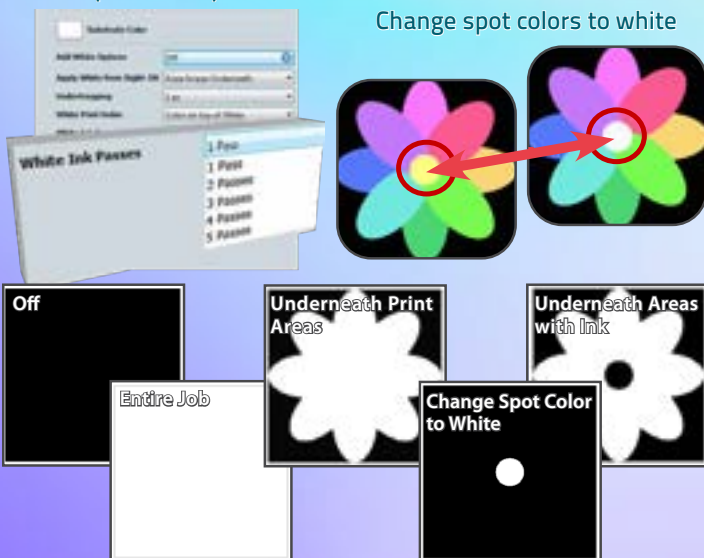

## Edit Job Images

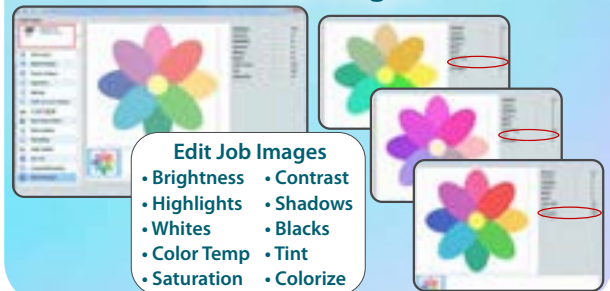

Imposition allows you to optimize your page layout by placing images in the maximum number of columns and rows while also supporting margins and gutters.





## SPECIFICATIONS



### PRINTING CAPABILITIES

<b>Imaging area:</b>	55" x 50" (139.7cm x 127cm)
<b>Max. media size:</b>	55" x 50" (139.7cm x 127cm)
<b>Min. media size:</b>	.5" x .5"
<b>Max. print height:</b>	3" (7.62cm)
<b>Print colors:</b>	CMYK + WWWW
<b>Resolution:</b>	720/1080/1440/2160/2880 DPI Resolutions
<b>UV lamp:</b>	Dual LED, low heat curing lamps

### INK AND MEDIA

<b>Ink type:</b>	UV, 500 mL bottles per color The maximum shelf life is 1 (one) year from Date of Manufacture (DoM). Once opened, the shelf life is 2 (two) months or 1 (one) year from DoM, whichever comes first.
<b>Media types:</b>	PVC plastic, styrene, wood, aluminum, metal, acrylics, coroplast, ceramics, fabric, leather composites, paperboard, foamboard, glass, carpet, tile and more

### PRINTER CONNECTIVITY

1-Gigabit Ethernet

### PREPRESS SOFTWARE

<b>Xanté iQueue Workflow:</b>	Adobe® PostScript® 3™/PDF Workflow, Independent CMYK Density Control, Spot Color Matching, Imposition, Digital File Editing, Variable Printing, and much more
-------------------------------	---

### WEIGHTS, DIMENSIONS

<b>Dimensions:</b>	90"L x 90"W x 24"H (229 x 229 x 60cm)
<b>Net/Gross weight:</b>	950lbs (430.9kg)
<b>Power supply:</b>	110v or 220v 50-60hz

### WORKING CONDITION

<b>Operating temperature:</b>	22-26°C (68°F - 78°F)
Relative humidity:	35-75RH

# XANTÉ

US: 251.473.6502

EU: +31 (0) 26.319.3210

[xante.com](http://xante.com)



Adobe® PostScript® 3™



**iQueue Simply Brilliant  
Workflow (Included)**

Digital Color Workflow with Advanced Color  
Matching and File Management Tools